

Galvanised steel / brass, robust and durable, for extremely high flow rates

One-hand quick disconnect couplings, one side sealing, that combine optimal flow rates (approx. 4 times as high as the popular standard coupling DN 7.2) with minimal coupling forces.

Suitable for all applications with an above-average air requirement and characterised by extreme conditions!

Operating pressure	Max. 16 bar
Temperature range	-20 °C to +100 °C
Flow rate (air)	3900 l/min
Material	Nickel-plated steel, nickel-plated brass
Sealant	NBR



410.43



410.53



410.65

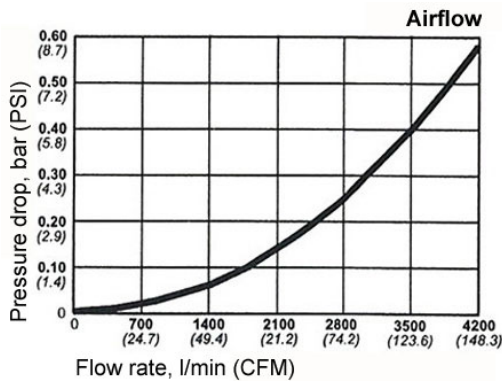

### Quick disconnect couplings DN 10, galvanised steel / brass, robust type, male

Art. No.	Ident No.	Connection	Length mm	a/f mm	Ø mm
410.42	107465	R 3/8 male	68.3	24	27.4
410.43	107466	R 1/2 male	70.8	24	27.4

### Quick disconnect couplings DN 10, galvanised steel / brass, robust type, female

Art. No.	Ident No.	Connection	Length mm	a/f mm	Ø mm
410.52	107467	G 3/8 female	62.8	24	27.4
410.53	107468	G 1/2 female	67.8	25	27.4

### Quick disconnect couplings DN 10, galvanised steel / brass, robust type, with hose stem

Art. No.	Ident No.	Connection	Length mm	a/f mm	Ø mm
410.64	107469	Stem, I.D. 10	77.3	24	27.4
410.65	107470	Stem, I.D. 13	75.8	24	27.4

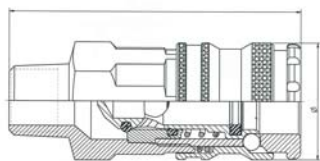

Male

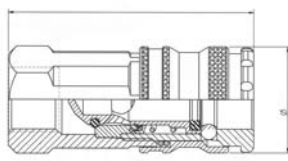

Female

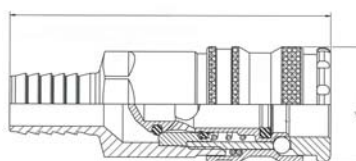

Hose connection

### Stems for couplings DN 10, hardened, galvanised steel, robust type

Art. No.	Ident No.	Designation	a/f mm	Length mm	L1 mm	L2 mm	Ø mm	D mm
410.91	107471	Stem I.D. 10	-	45.5	21.3	21.0	10.4	17.0
410.92	107472	Stem I.D. 13	-	45.0	21.3	21.0	10.4	17.0

### Plugs for couplings DN 10, hardened, galvanised steel, robust type, male

Art. No.	Ident No.	Designation	a/f mm	Length mm	L1 mm	L2 mm	Ø mm	D mm
410.93	107473	Plug R 3/8 male	17	41.0	21.3	11.4	10.4	15.1
410.94	107474	Plug R 1/2 male	22	47.5	21.3	15.0	10.4	15.1

### Plugs for couplings DN 10, hardened, galvanised steel, robust type, female

Art. No.	Ident No.	Designation	a/f mm	Length mm	L1 mm	L2 mm	Ø mm	D mm
410.95	107475	Plug G 3/8 female	20	38.0	21.3	11.4	10.4	15.1
410.96	107476	Plug G 1/2 female	27	43.5	21.3	15.0	10.4	15.1



410.92



410.93



410.95

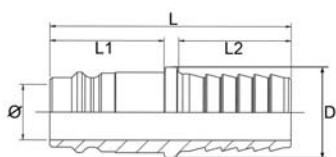

Stem

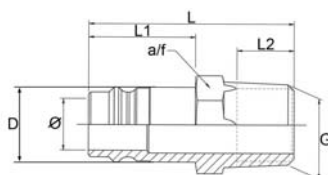

Plug male

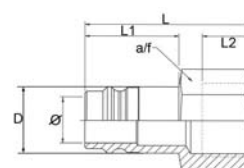

Plug female